

# Make Money Now!

In every issue, the *Bead Design Studio* staff brings you a copyright-free project design that you can use however you like, with no obligation to us! You have our permission to:

- Recreate the design and sell the finished piece
- Sell kits for the design to your customers
- Download and print the instructions from our website to teach the design in a class

## Forever Floral Necklace



Project instructions courtesy of  
*Bead Design Studio*

### What You'll Need

#### Materials:

- 1 *JHB Eclectic Collection Grande* Camelia button—Antique Brass, #92557
- *Kabela Design:*
  - 6 6mm Crystal-trimmed round beads
  - 3 Crystal flower links
  - 1 crystal from Swarovski cup chain
- 1 *Vintaj® Natural Brass Co.* 42mm Passion Flower Petal Filigree—Natural Brass, #F400
- 14 Jump rings
- 8 21-ga. Eye pins
- 12 in. *Primitive Earth Beads and Chain* chain—antique brass, #CH-75
- 1 Clasp

#### Tools:

- Chain nose pliers (2 pairs)
- Round nose pliers
- Wire cutters

#### Additional Supplies:

- Basic beading supplies, *E-6000®* Adhesive

**Dimensions:** 16 in.  
Beginning project

#### Instructions:

##### Flower Focal

1. Clip the shank off the back of the button.
2. Pick up the Flower Filigree and use chain nose pliers to begin to bend each petal down. Set the button into the Filigree, and then finish bending the petals down securely around the button.
3. Cut one piece of crystal from the Swarovski cup chain and glue it to the center of the button with a little *E-6000®*. Set aside to dry.

##### Necklace Chain

1. Slide a crystal bead onto an eye pin and create a simple wire loop at the end (**Fig. 1**). Repeat to create a total of six crystal bead links. Set three aside.

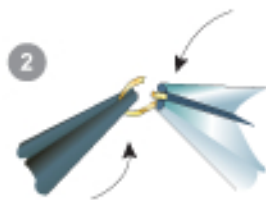
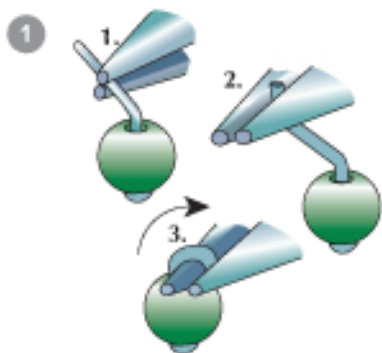

2. Use jump rings to link three crystal bead links together, making sure you pull the jump rings apart as shown in **Fig. 2**.

3. Cut the 12 in. of chain in half and set one-half aside. Use a jump ring to attach one chain to one end of the crystal bead chain, and another jump ring to add a crystal flower link to the other end.

4. Use a jump ring to attach the flower link end of the chain to one side of the Filigree Flower.

5. Repeat Steps 2–4 to complete the other side of the necklace.

6. Cut one loop off the remaining crystal flower link. Use two jump rings to attach the link to the bottom of the Filigree Flower.

7. Adjust the length of your necklace by cutting chain from each end, if desired. Attach one-half of the clasp to each end of the necklace with jump rings.

To download and print this project sheet, visit [BeadDesignStudioMag.com](http://BeadDesignStudioMag.com).